

## **IMPORTANT SAFETY INFORMATION**

**READ AND FOLLOW ALL SAFETY INSTRUCTIONS**

---

**FOR FIELD ASSISTANCE PLEASE CALL  
+1-213-255-2060 #4**

---

- Before wiring to power supply and during servicing or relamping, turn off power at fuse or circuit breaker.
- All servicing or relamping must be performed by qualified service personnel.
- Product must be grounded to avoid potential electric shock or other potential hazard.
- Product must be installed at locations and heights, in a manner consistent with its intended use, and in compliance with electrical code and local codes.

**SAVE THESE INSTRUCTIONS FOR FUTURE REFERENCE**

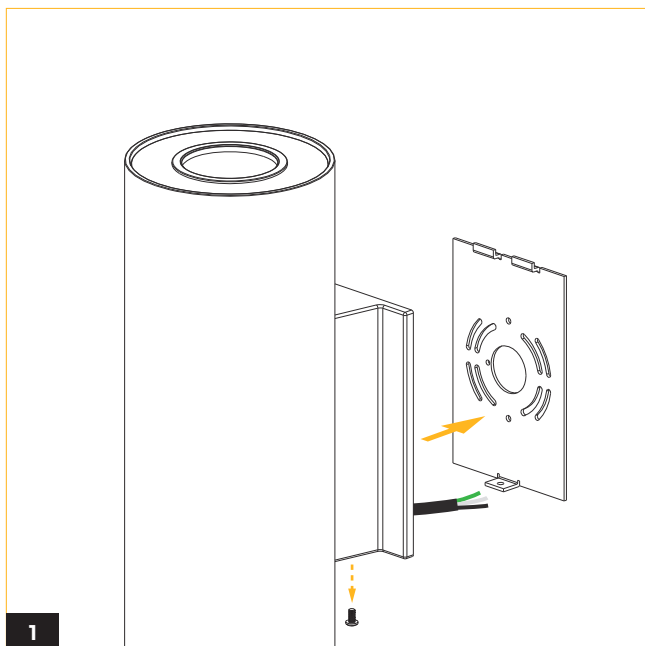

1 Detach mounting plate from cylinder.

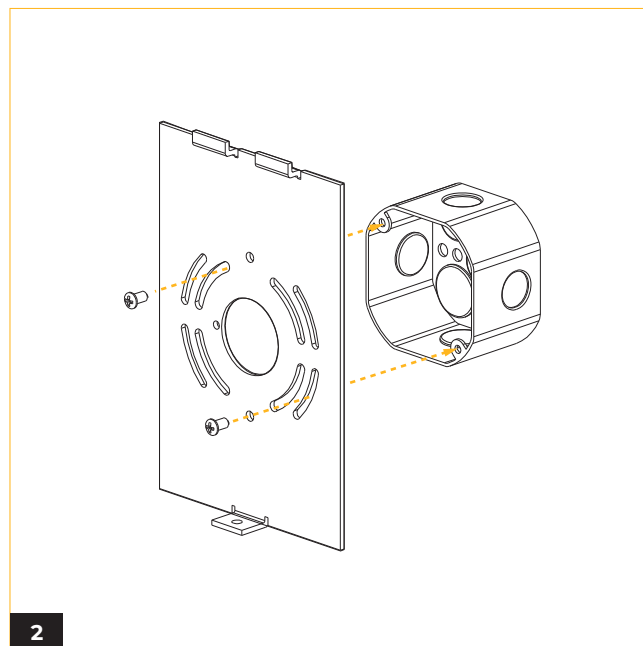

2 Attach mounting plate to junction box with screws from junction box (by others).

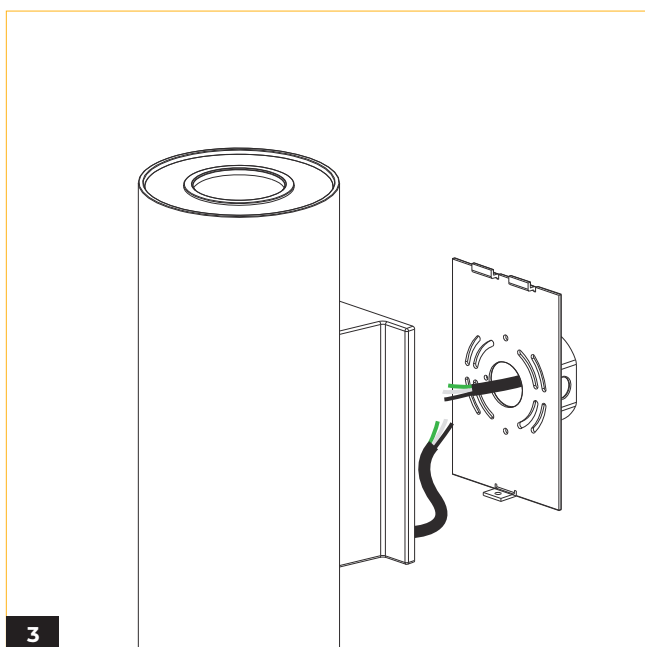

3 Make electrical connections depending on dimming type (see wiring diagram).

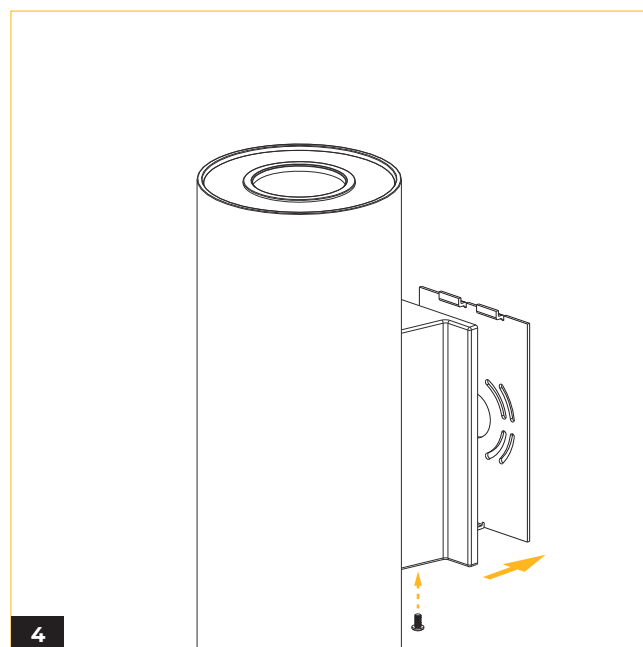

4 Attach cylinder fixture to mounting plate and secure by tightening the screw.

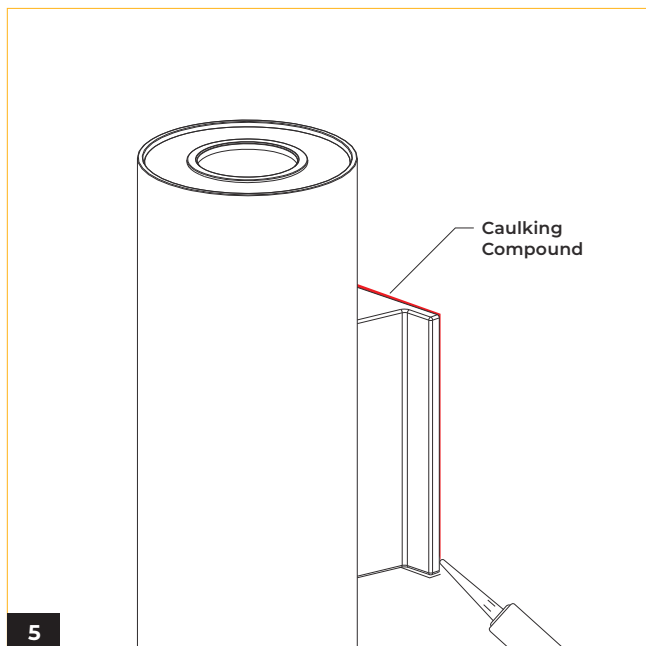

Fixtures used in wet locations, place a bead of silicone-based caulking compound along where the mounting bracket meets the wall on the top and on each side.

## WIRING DIAGRAM

### STVS / SPVS

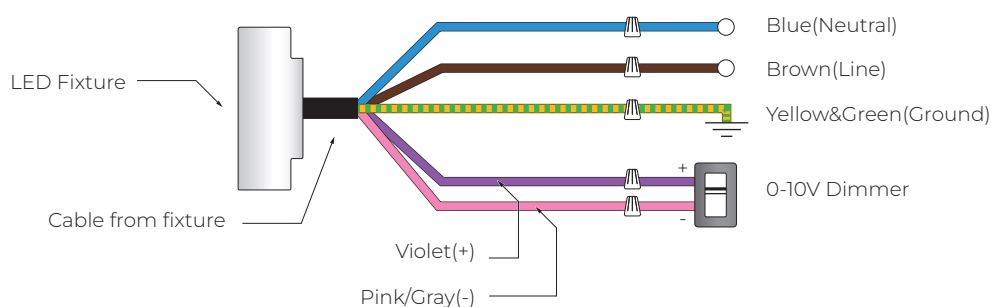

### STVD / SPVD

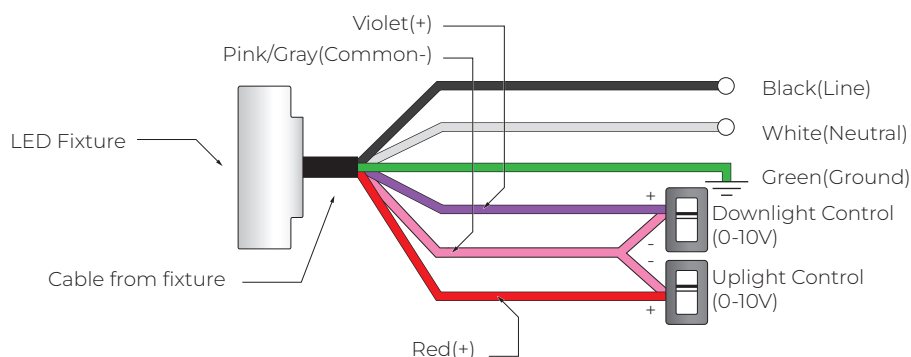

### DMX

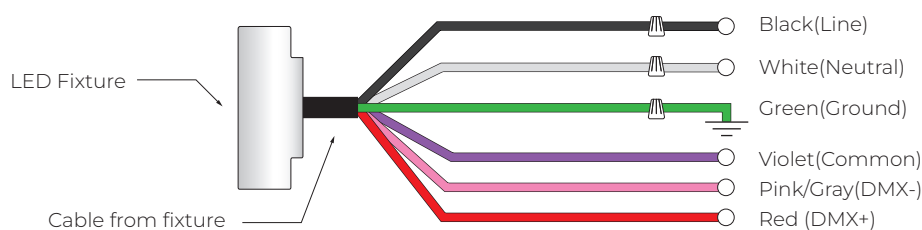

## WIRING DIAGRAM

NOD

