

IMPORTANT SAFETY INFORMATION

READ AND FOLLOW ALL SAFETY INSTRUCTIONS

**FOR FIELD ASSISTANCE PLEASE CALL
+1-213-255-2060 #4**

- Before wiring to power supply and during servicing or relamping, turn off power at fuse or circuit breaker.
- All servicing or relamping must be performed by qualified service personnel.
- Product must be grounded to avoid potential electric shock or other potential hazard.
- Product must be installed at locations and heights, in a manner consistent with its intended use, and in compliance with electrical code and local codes.

SAVE THESE INSTRUCTIONS FOR FUTURE REFERENCE

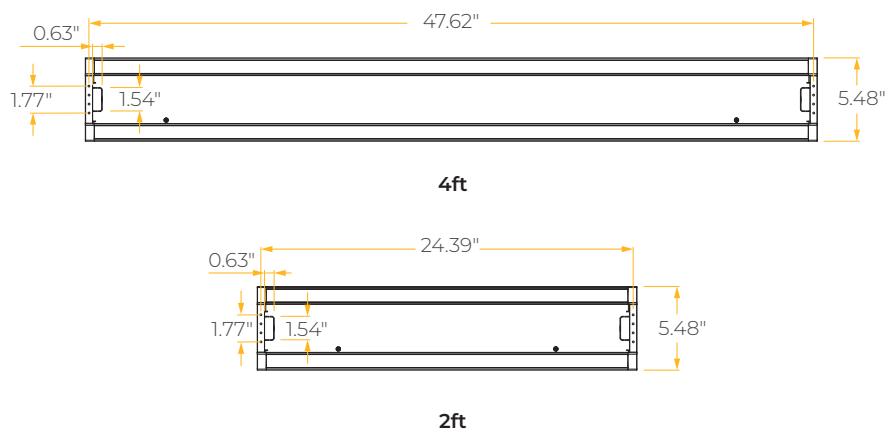

DIMENSIONS

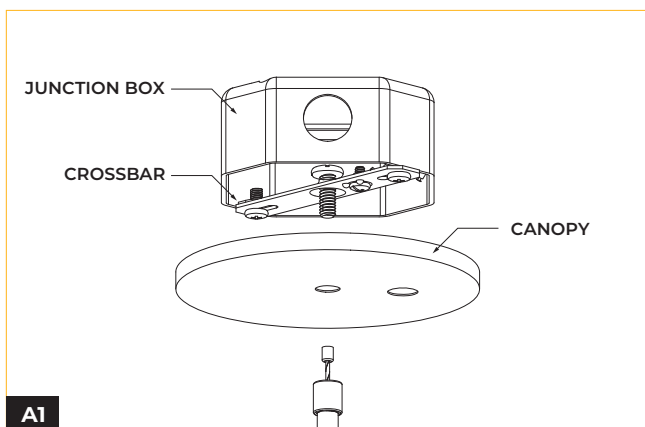

Secure the crossbar to the 4" junction box (by others)
* Use UL approved junction boxes.

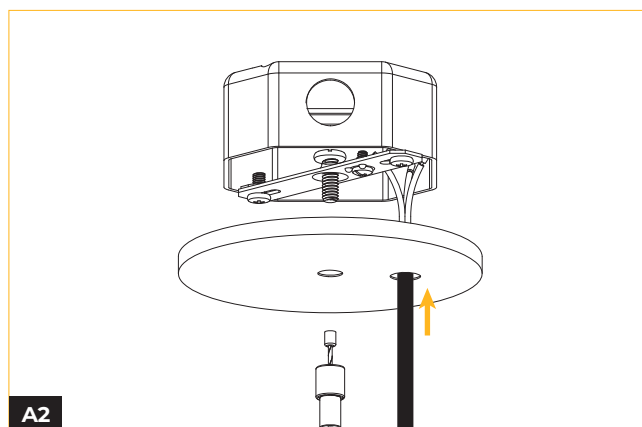

Thread the power cord and dimming wires through the canopy wire hole.

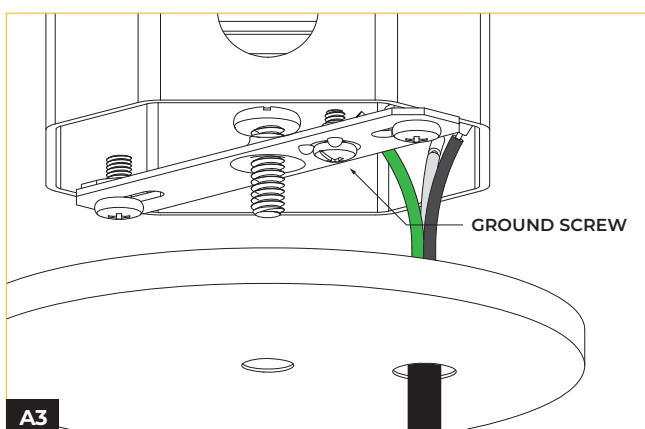

Connect the ground conductor to the ground screw on the crossbar, then connect the line and neutral wires according to the wiring diagram.

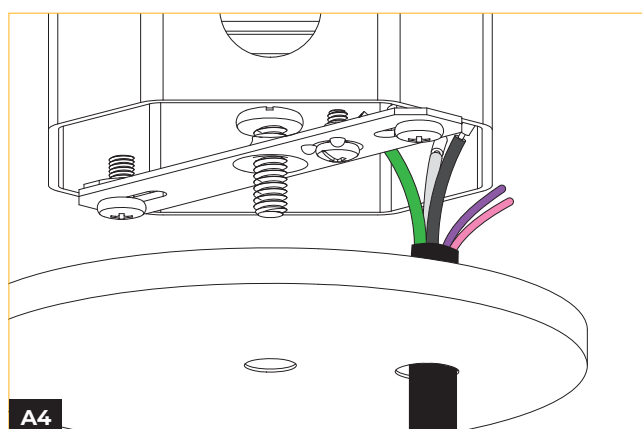

For 0-10V dimming option, connect the two remaining conductors according to the wiring diagram.
* Make all connections with UL approved connectors.

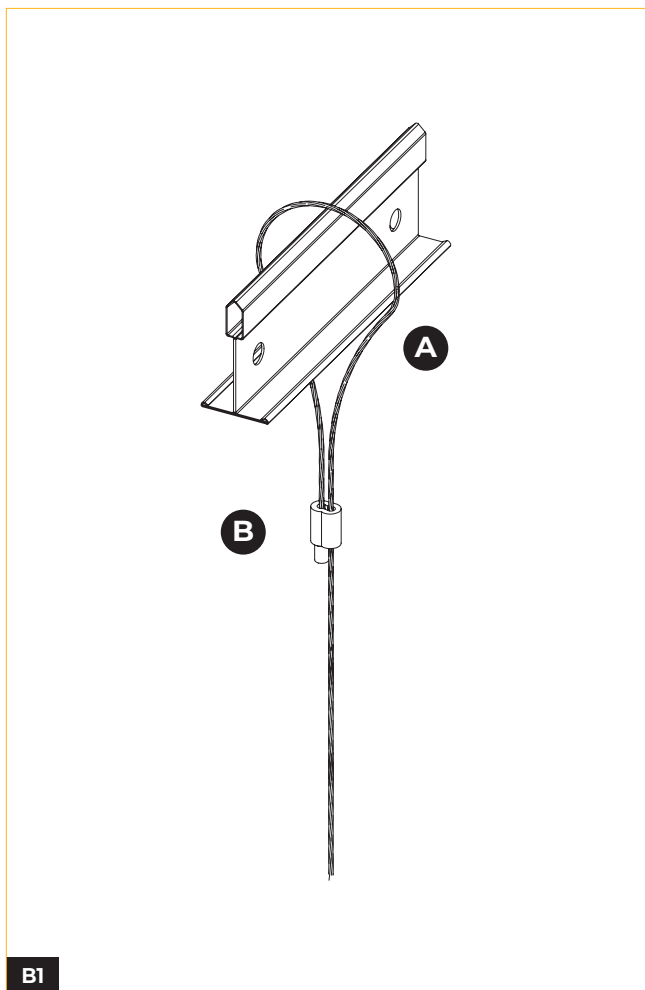

(A) Loop the existing cable around the on-site structural support. Ensure the cable is properly positioned and securely fastened to the support structure.

(B) Loop the adjustable cable through the length adjuster, fastening securely at the desired height to ensure stable suspension of the fixture.

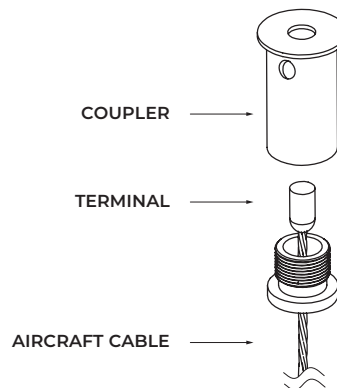
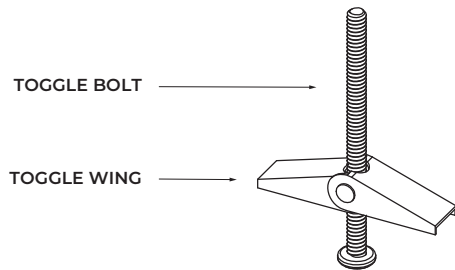

INCLUDED PARTS

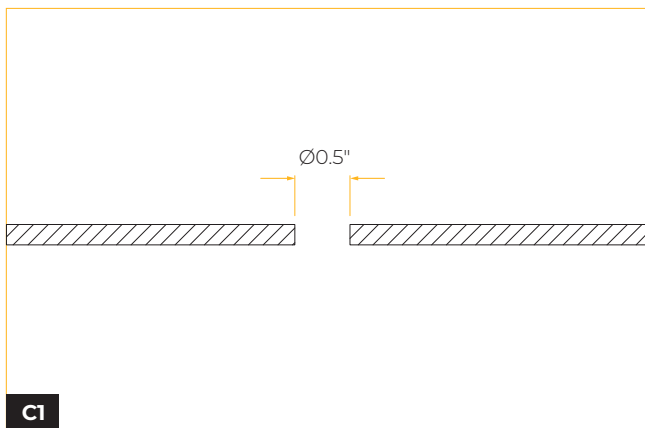

Cut a 0.5 inch hole in the ceiling. Ensure the hole is clean and free of debris before proceeding.

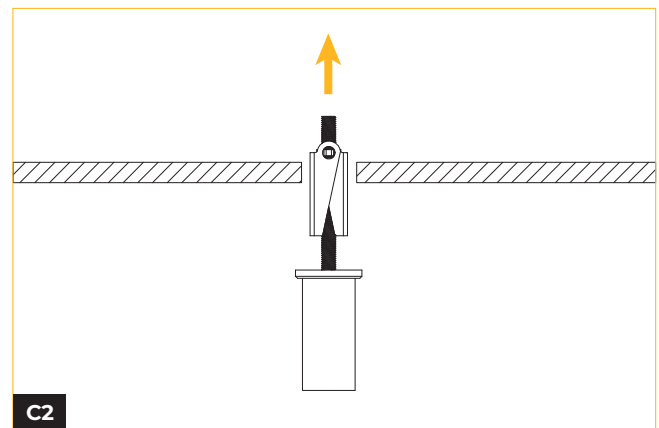

Insert the toggle bolt through the coupler, then pass the assembly through the ceiling opening.

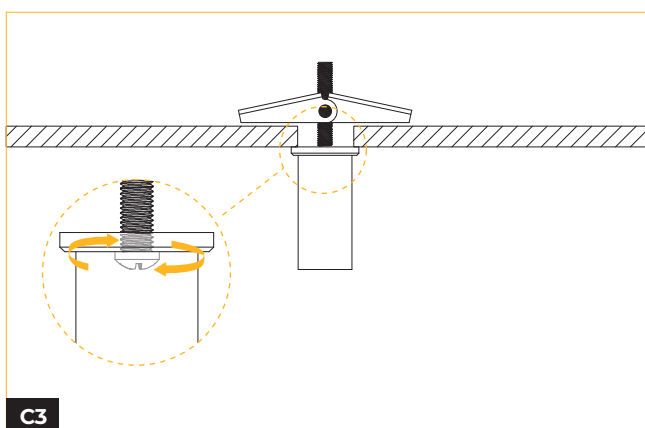

Tighten the screw firmly to secure the coupler against the ceiling surface.

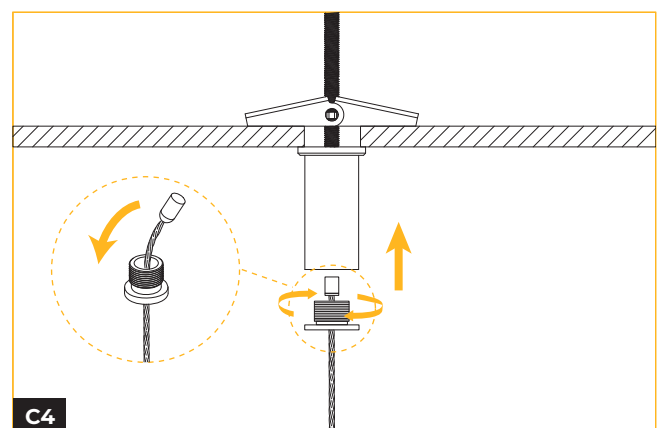

Feed the aircraft cable through the coupler until the terminal locks securely into place. Screw in the assembly to confirm a firm and secure fit.

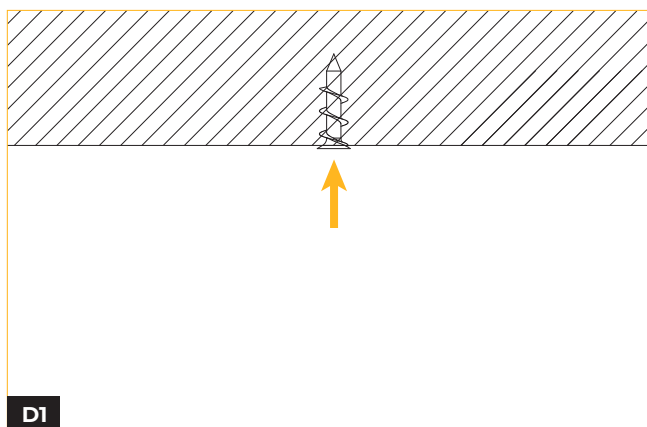
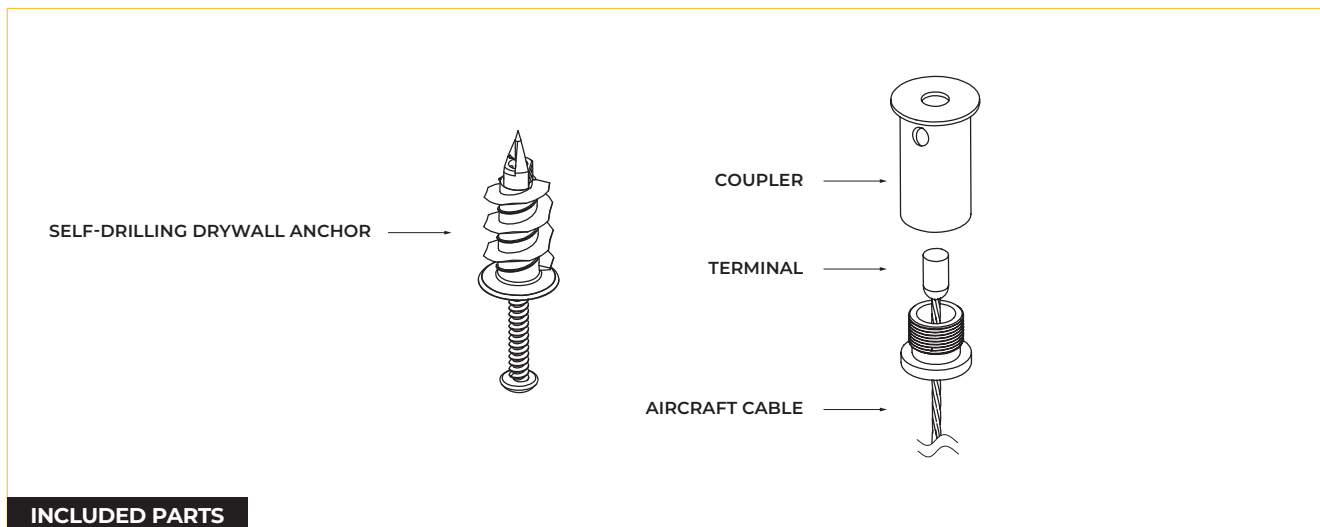

Drill the self-drilling drywall anchor into the ceiling. Ensure the anchor is firmly secured and flush with the surface.

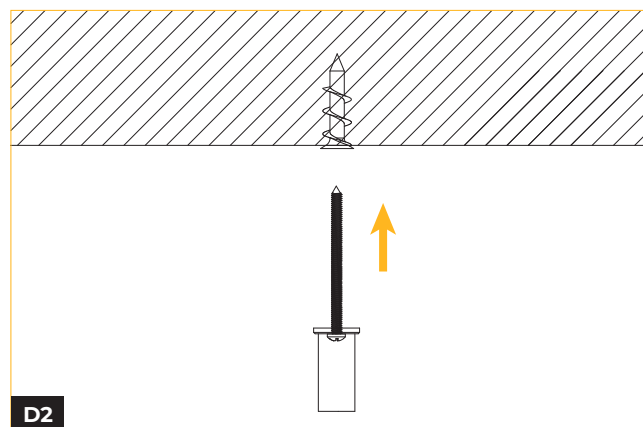

Insert the screw through the coupler and drive it into the drywall anchor. Ensure the screw is fully tightened for a secure installation.

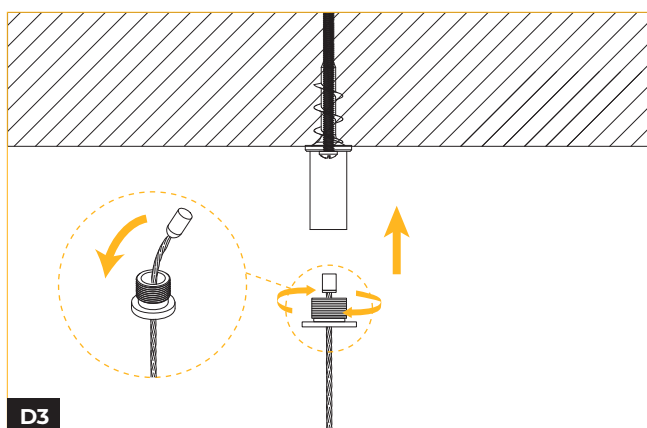

Feed the aircraft cable through the coupler until the terminal locks securely into place. Screw in the assembly to confirm a firm and secure fit.

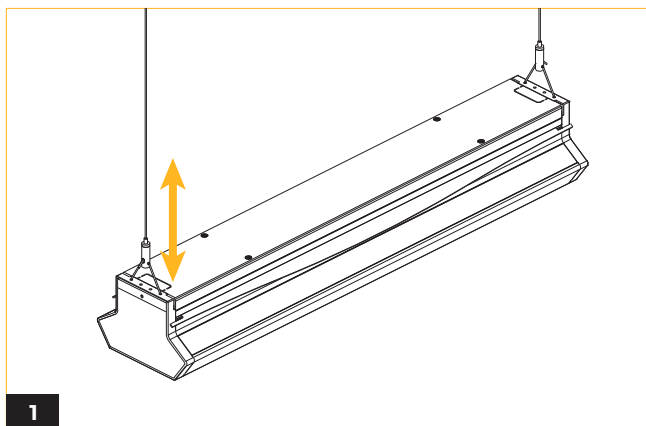

1

Continue the installation by following one of the previously outlined ceiling mounting methods. Insert the aircraft cable through the gripper and plunger assembly, then adjust the plunger to set the cable to the desired length. Ensure the cable is firmly secured before releasing.

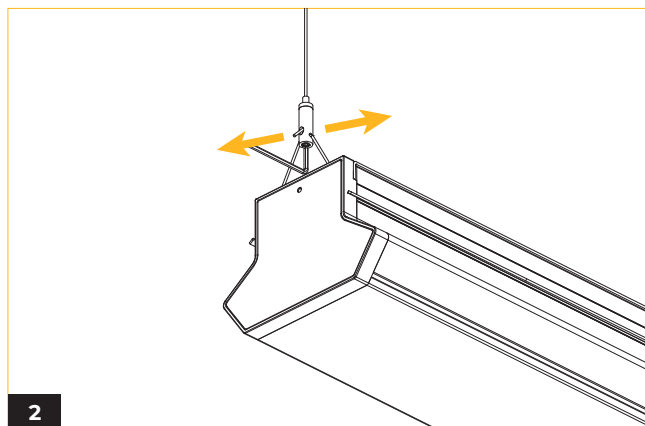

2

Tighten the lower adjustment screw to ensure the fixture remains level and balanced.

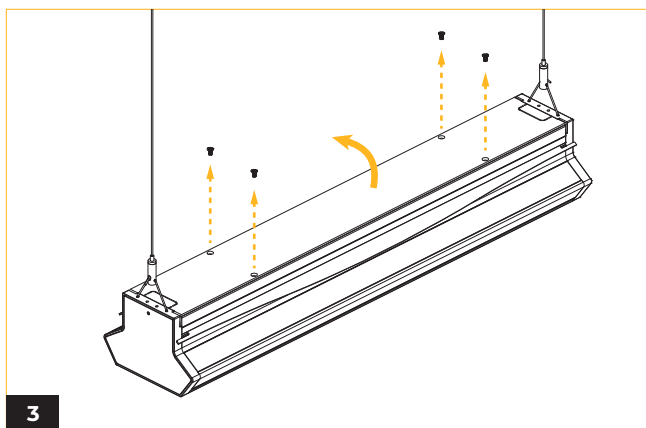

3

Remove the four screws and swing open the hinged top cover to access the internal components.

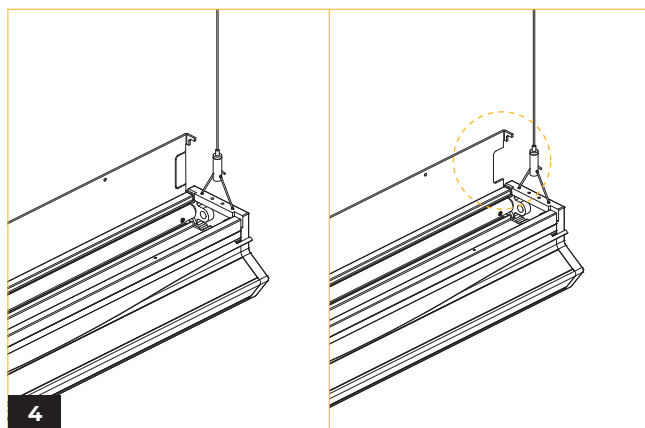

4

Remove the rectangular knockout on the top cover to create clearance for wiring where needed.

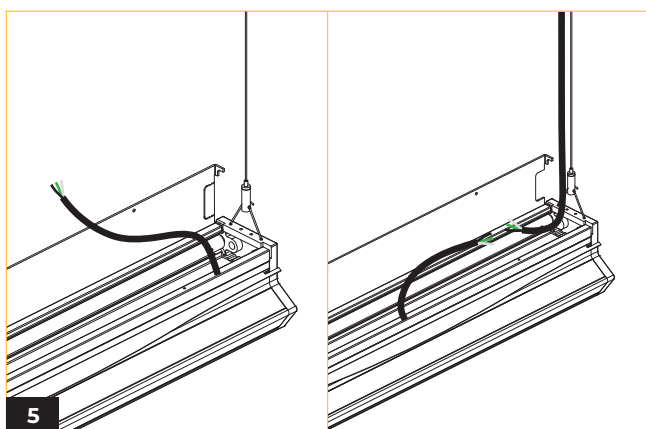

5

Guide the power cables through and make the electrical connections to the fixture's internal wiring (refer to the wiring diagram). Ensure all connections are properly secured.

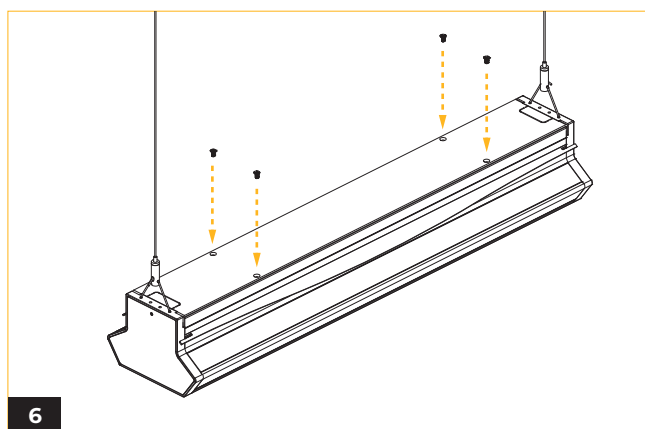

6

Close the top cover and secure it in place with screws.

WIRING DIAGRAM

NOD

*Not to scale

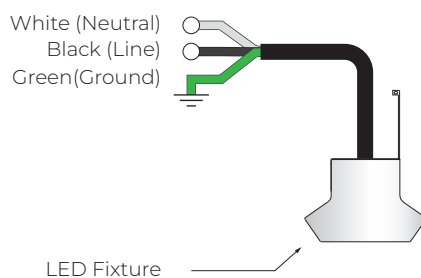

STV 0-10V

*Not to scale

